

inSwan

INS-1

USB Document Camera

Quick Guide

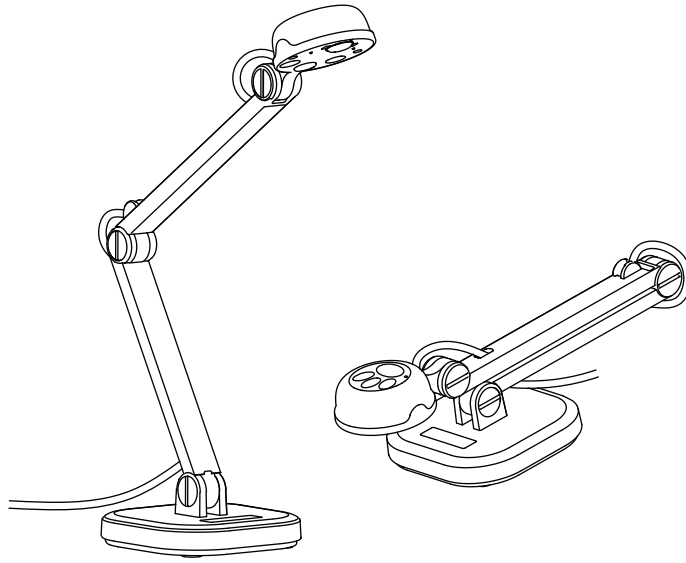

TS-82-927-01010-005_v1.1

Package Content:

- INS-1 USB Document Camera
- Quick Guide (this page)
- Anti-Glare Sheet
- Microscope Adapters

Customer Service

Email : service@inswan.com
Website : <http://www.inswan.com>

A | INS-1 USB Document Camera overview

- 1 LED Lamp
- 2 Microphone
- 3 Camera
- 4 Lamp Button
- 5 Auto Focus Button
- 6 Brightness Adjusting Button
- 7 USB Cable
- 8 Camera Indicator

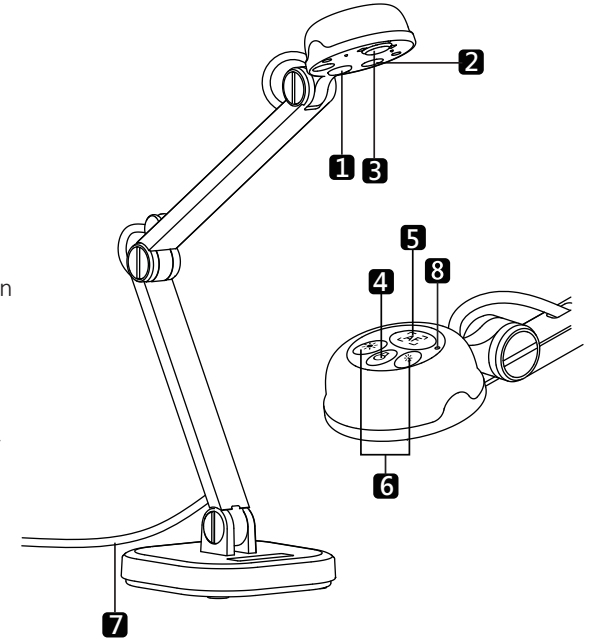

B | Installing application software on computer/laptop

INS-1 requires the **Documate** application software to function. Please download the latest version for PC, Mac, or Chromebook at www.inswan.com.

C | Connecting INS-1 and computer/laptop with USB cable.

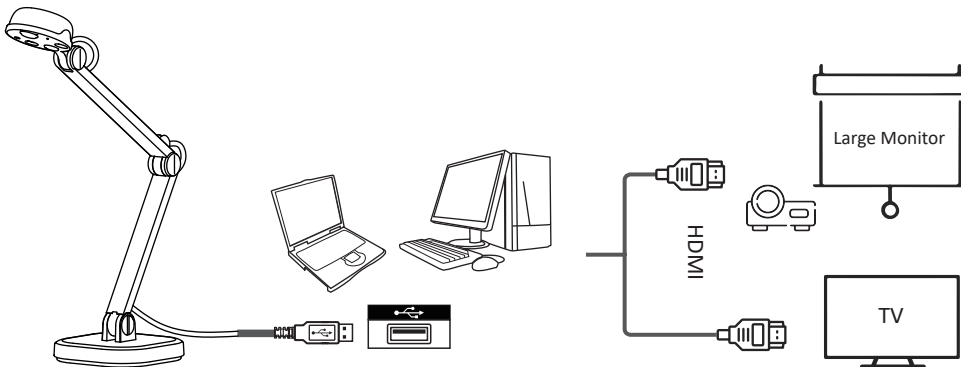

D | Working with application software

Start application on your computer/laptop and choose the desired operation mode.

Recording video and image capture

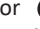
Click  to take snapshots or  to record video clips for future use.

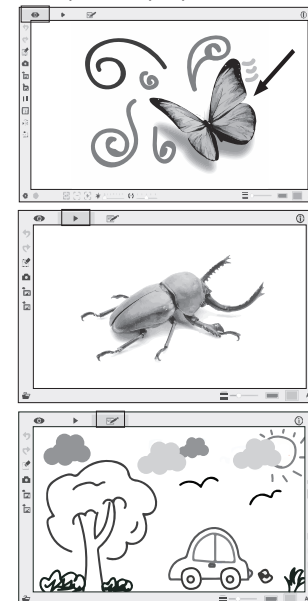

Live mode (default):
Shows a live image captured by the INS-1 and provides various functions to enhance your presentation.



Playback mode:
Review and/or edit snapshots and video clips taken by INS-1 or other devices.



Drawing mode:
Provides a whiteboard space with markup tools to add text, create drawings or markup existing images.



More detailed Instructional videos are available at www.inswan.com.

E | Adjusting INS-1 position

Change the height and/or positioning of the INS-1 multi-joint document camera to capture a wide variety of objects.

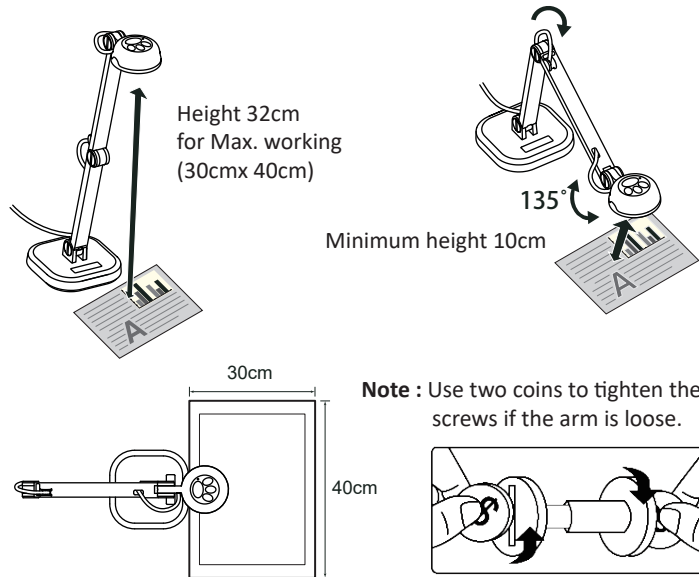

I | Anti - glare

Eliminate glare from glossy surfaces (e.g., magazine pages) by overlaying the anti-glare sheet.

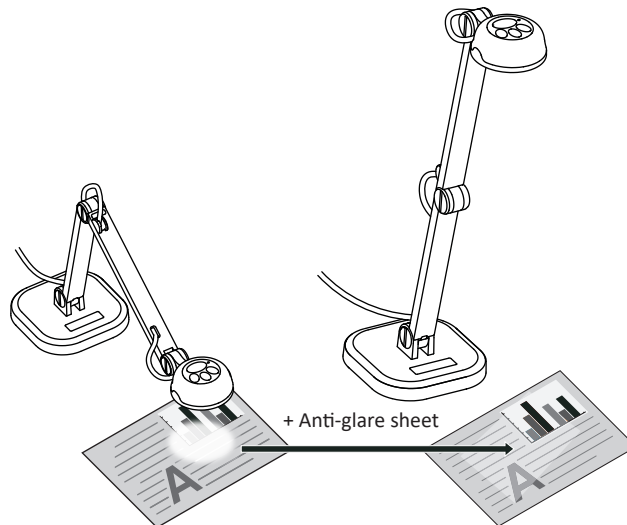

F | Adjusting focus



The Auto Focus button automatically adjusts to optimal focus one time.

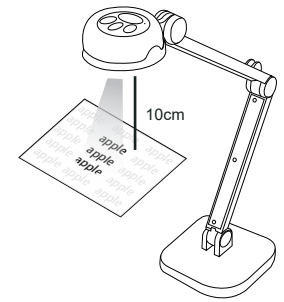

G | Adjusting brightness

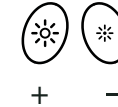

Adjust brightness levels up or down with the Brightness button.

Press these two buttons at the same time to change the image orientation when capturing images for a live show.

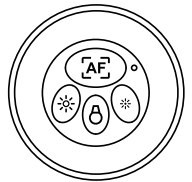

H | Supplemental illumination



Turn on the LED lamp to improve image quality in dark environments.

J | Connecting a microscope(advanced operation)

Connect your INS-1 to a microscope to project microscopic objects on a big screen.

1. Adjust the microscope and focus on the desired object.
2. Choose an appropriate microscope adapter.

Microscope adapter accessories are applicable to Ø28mm ,Ø31mm, Ø33mm, and Ø34mm eyepieces.

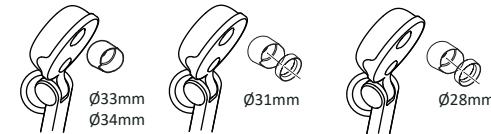

3. Mount the microscope adapter to the lens.

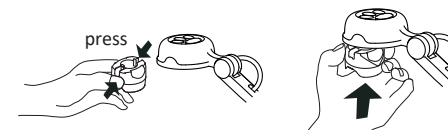

4. Connect the lens with microscope adapter to the microscope.

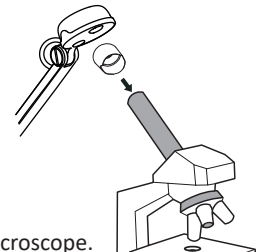

For more advanced operation , please visit our official site at www.inswan.com.